

ORACLE®

CAMARO AFTERBURNER



TAIL LIGHT HALO INSTALLATION GUIDE

TOOLS:



SCREWDRIVER

HEAT SOURCE

ADHESIVE



IN ORDER TO OPEN THE LIGHT WE WILL FIRST NEED TO HEAT THE HOUSING. IF USING A HEAT GUN BEGIN BY HEATING THE SEAL EVENLY WHILE CONSTANTLY MOVING THE HEAT GUN. IF USING AN OVEN: PREHEAT TO 225°F AND PLACE THE LIGHT IN THE OVEN FOR 10 MINUTES.



- PRE-HEAT THE OVEN TO 225°F (OR 100°C)
- CENTER LIGHT IN OVEN FOR EVEN HEATING
- SET TIMER FOR 10 MIN (GAS OR ELECTRIC)



Scan code for DIY video for Afterburner install.

REMOVING THE TAIL LIGHTS:

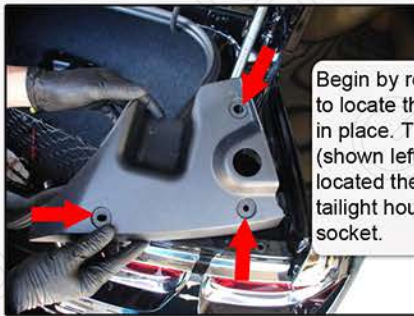

Begin by removing the plastic cover to locate the bolts holding the tail light in place. There should be 3 clips (shown left). Once cover is removed, locate the nuts in the back of the taillight housing. Use a wrench or socket.

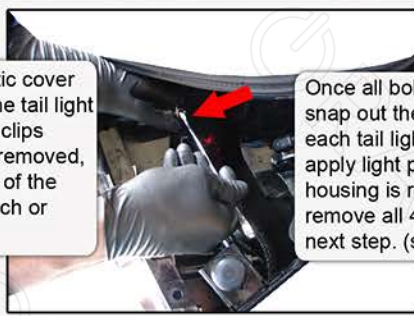

Once all bolts are loose. Carefully snap out the chrome housing around each tail light. Use a screwdriver and apply light pressure until each chrome housing is removed. You can then remove all 4 tail lights and begin the next step. (see oven instructions)

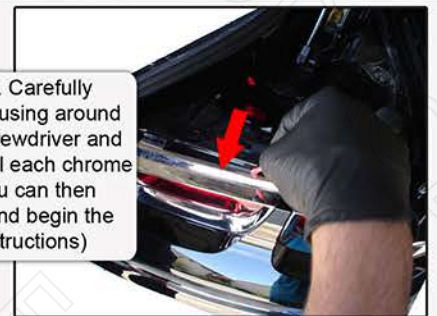

OPENING THE TAIL LIGHTS:

Method 1

Method 2

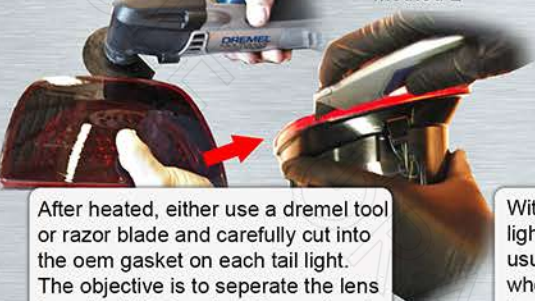

After heated, either use a dremel tool or razor blade and carefully cut into the oem gasket on each tail light. The objective is to separate the lens from the light housing. Remember to use caution, housing may be hot.

INSTALL THE RINGS:



With a power drill, drill into each tail light housing. In the upper corner is usually the easiest drill into. This is where you will feed the wires from the halos into.

SEAL THE RINGS:



Now remove the 3M backing off of each halo ring. The rings are cut to fit flush with the tail light design. Place them evenly, and apply firm pressure for about 10-15 seconds.

With exterior grade silicon, apply a smooth bead around the edge of the tail light housing. Now place the lens (red) back onto the housing. Apply liberal pressure, and wipe away any excess silicon. Allow time for silicon to dry before moving on.

WIRING THE TAIL LIGHTS:

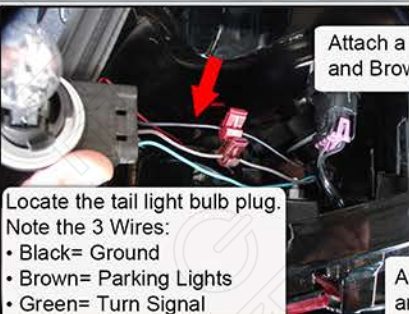

Attach a T-Tap to the Black and Brown Wires.

Locate the tail light bulb plug. Note the 3 Wires:
 • Black= Ground
 • Brown= Parking Lights
 • Green= Turn Signal

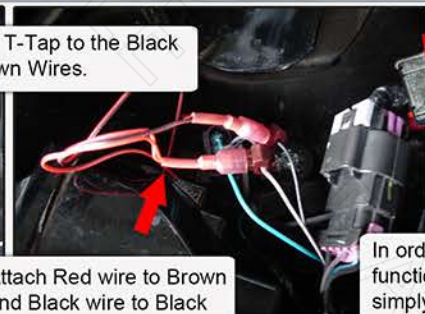

Attach Red wire to Brown and Black wire to Black



In order to disable the parking light function of the factory bulb you can simply disconnect one of the pins.



Install the factory covers, chrome housing and test your brakes. Questions about installation call (800) 407-5776